

ITEM NO.	PART NUMBER	DESCRIPTION	MATERIAL	QTY.
1	FP-APEX-306	FRONT FLOOR 305 APEX	1/8" FLOOR PLATE	1
2	FP-PS-FLPL-LID	PS LID	1/8" FLOOR PLATE	1

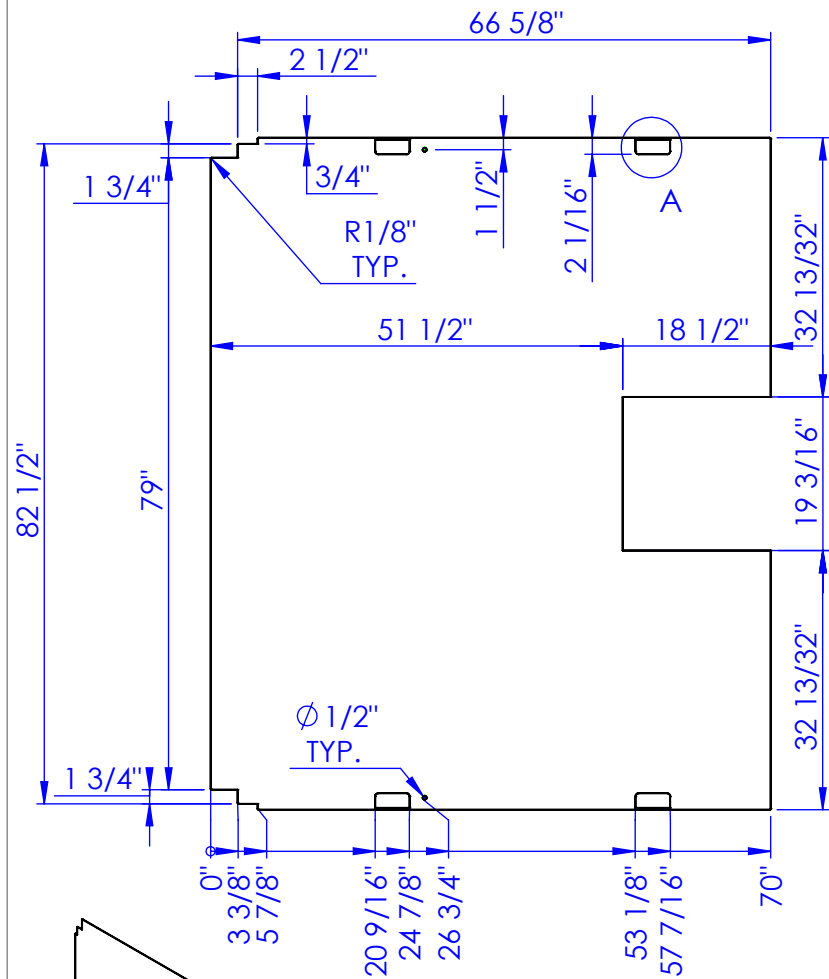

NOTE:  
1. EDGES MUST BE COMMON BETWEEN FLOOR & DOOR.  
TO INSURE PATTERN MATCH AT ASSEMBLY.

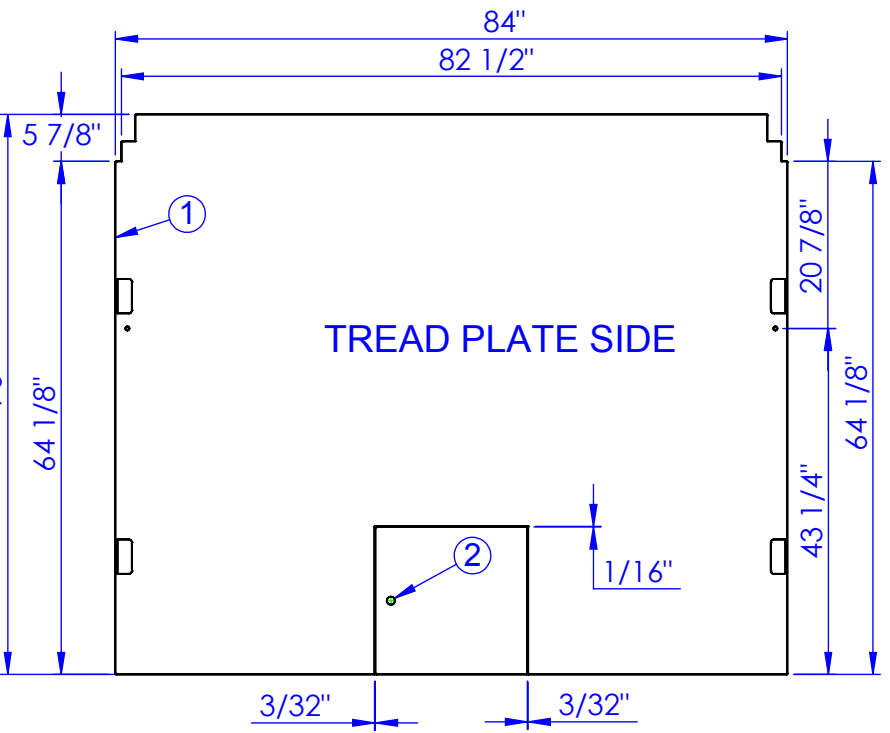
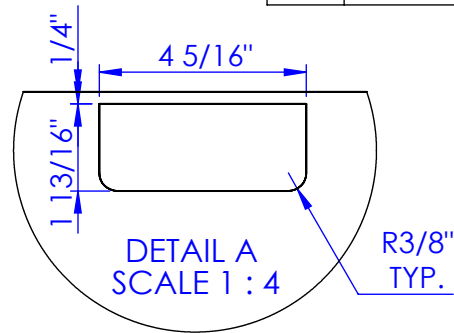
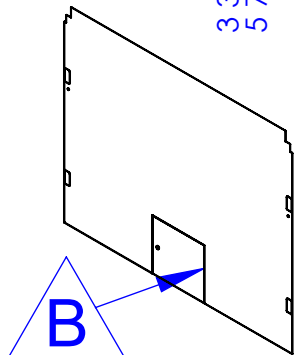

REVISIONS			
REV.	DESCRIPTION	DATE	APPROVED
B	REV. STAKE POCKET SIZE	12/21/2011	

DIMENSIONS ARE IN INCHES  
TOLERANCES:  
FRACTIONAL  $\pm 1/16$   
ANGULAR: MACH  $\pm 1$  BEND  $\pm$   
TWO PLACE DECIMAL  $\pm 0.010$   
THREE PLACE DECIMAL  $\pm 0.005$

MATERIAL 1/8" FLOOR PLATE  
DO NOT SCALE DRAWING

NAME	DATE
DRAWN HEATH	12/12/12
PART # FP-APEX-306	
ASM #	
COMMENTS:	
FRONT FLOOR, 305 APEX	

P.O. BOX 248,  
SABETHA, KS 66534

**TRIPLE C**  
INC.

SIZE	DWG. NO.	REV.
A	00-2211 B	B
SCALE: 1:24	WEIGHT:	SHEET 1 OF 1